

## FA211A+FA130C Wind speed and direction vane

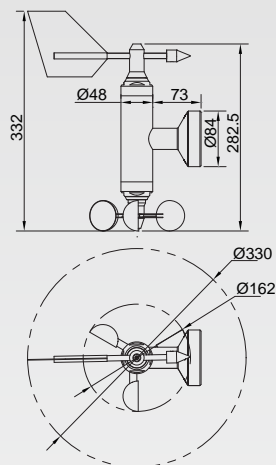

FA211A

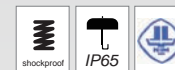
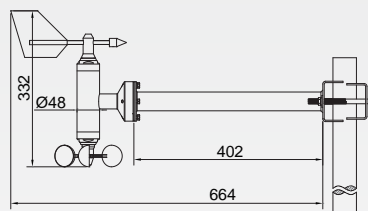

FA211A+PJ3001

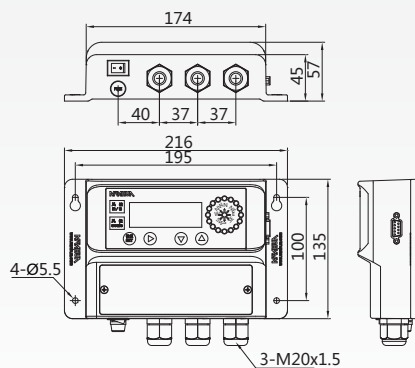

FA130C

### Application

Special design for plant, electric power, harbor, factories and mines, wind generator etc large mechanical equipments.

### Main Functions & Features

- Anemometer sensor use magnetic sensor measuring principle.
- Sensor data collected with high precision and reliability.
- Wind speed measurement with wide range, low wind speed start.
- Wind speed sensor/vane use metal enclosure, corrosion resistant and strong anti - wind capability
- Wind cup stainless steel can be used in harsh conditions.
- Compact sensor design, set wind speed measurement, heating device in one, easy installation and maintenance.
- Sensor fault - tolerant design, sensor will not be damaged even wrong wiring.
- Multilevel lighting protection and surge protection.
- Work over a wide voltage range.

### Specification

Description	Parameter
Voltage	VCC = DC12 - DC30V
Wind speed range	0.5 - 50m / s
Wind speed Signal	UART signal
Wind direction range	0 ~ 360°
Wind direction signal	4 ~ 20mA current (linear correspond 0 ~ 360°), load resistance ≤ 500Ω
Heating voltage	DC24V ± 6V
Heating type	Automatic
Surge protection	4KV /2KA
Start speed	≤ 0.5m / s
Accuracy	± 0.5 m / s (<5m/s) Measuring vale ± 3% (≥5 m/s)
Accuracy	± 3°
Heating power	≤ 100W
Anti-wind level	> 70 m / s
ESD protection	15KV
Ambient temperature	-40°C ~ +70°C
IP protection	IP65
Humidity	0% ~ 99%
Body material	Aluminum alloy / Fluorocarbon coating
Wind cup material	Stainless Steel 304
Bearing material	Stainless Steel 440C
Vane material	Carbon fiber + stainless steel 304
Bearing supplier	NMB / EZO
Weight	2.8KG



FA211A



FA211A+PJ3001



FA130C