

FA132X Wind direction sensor

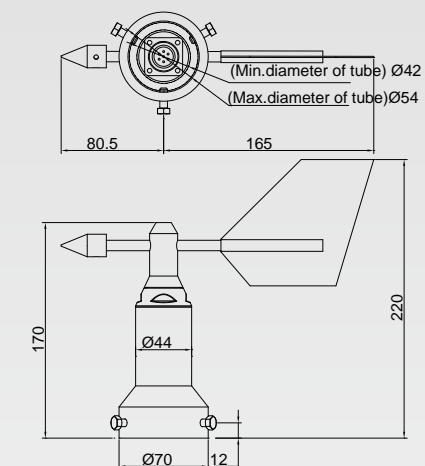

FA132A

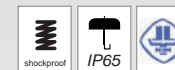
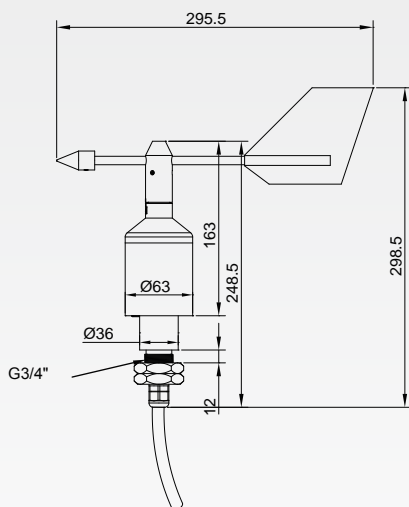

FA132D

Application

Special design for plant, electric power, harbor, factories and mines, wind generator etc large mechanical equipments.

Main Functions & Features

- Based on magnetic sensor measuring principle.
- Sensor data collected with high precision and reliability.
- Wind speed measurement with wide range, low wind speed threshold.
- Full metal enclosure with corrosion resistant and strong anti – wind capability.
- Compact sensor design, integrates wind direction measurement and heating device. Easy installation and maintenance.
- Fault – tolerant design, sensor will not be damaged even wrong wiring.
- Wide supply power voltage range.

Specification

Description	Parameter
Operation voltage	VCC=DC12V – DC30V
Mesuring range	0° ~ 360°
Threshold	≤ 0.5 m / s
Anti – wind levrl	70 m / s
Accuracy	± 3°
Heating type	Automatic
Heating voltage	DC24V
Heating power	≤ 50W
Surge protection	6KV / 5KA
ESD protection	15KV
Signal output	4 ~ 20mA three – wire current loop (linear mapping 0 ~ 360° direction); load resistance ≤ 500Ω
Ambient temperature	-40°C ~ +60°C
IP protection	IP65
Humidity	0% ~ 99%
Weight	0.5 KG
Vane material	carbon fibre + stainless steel
Body material	carbon fibre + aluminum alloy
Bearing	Stainless Steel and Special lubricants

Model	Mounting method	Wiring	Signal
FA132A	Φ42 ~ Φ52 pipe	Aviation plug connector	4 ~ 20mA three-wire current loop (linear mapping 0-360° direction); load resistance≤500Ω;
FA132D	G3 / 4" whorl	Lead wire	



FA132A



FA132D