

FA131A / FA133A / FA135A



FA131D / FA133D / FA135D

FA13 series wind speed sensor

Application

Special design for plant, electric power, harbor, factories and mines, wind generator etc large mechanical equipments.

Main Functions & Features

- Anemometer sensor use magnetic sensor measuring principle.
- Sensor data collected with high precision and reliability.
- Wind speed measurement with wide range, low wind speed start.
- Wind speed sensor / vane use metal enclosure, corrosion resistant and strong anti – wind capability.
- Wind cup stainless steel can be used work in harsh conditions
- Compact sensor design, set wind speed measurement, heating device in one, easy installation and maintenance.
- Sensor fault – tolerant design, sensor will not be damaged even wrong wiring.
- Multilevel lighting protection and surge protection.
- Work over a wide voltage range.

Specification

Description	Parameter
Operating voltage	VCC=DC12V – DC30V
Measuring range	0.5 ~ 50m/s
Wind speed start	≤ 0.5m / s
Anti – wind intensity	70 m / s
Precision	± 0.5 m / s (<5m/s) ; Measure data ± 3% (≥ 5 m / s)
Heating type	Automatic
Heating voltage	DC24V ± 6V
Heating power	≤ 50W
Surge protection	4KV / 2KA
ESD protection	15KV
Ambient temperature	-40°C ~ +70°C
Humidity	0% ~ 99%
Wind cup	Stainless Steel
IP protection	IP65
Bearing	Stainless Steel 440C
Weight	0.6KG
Enclosure	Aluminum alloy / Fluorocarbon coating
Bearing supplier	NMB / EZO
Signal output	UART

Model	Mounting method	Wiring	Signal
FA131A	Φ42~Φ54 pipe	Aviation plug connector	Asynchronous serial port output, baud rate 300, eight bit data, no parity, one stop bit, signal range 0 ~ VCC. Match Nanhua FA101C or FA130C display panel.
FA131B	Self-balanced	Lead wire	
FA131D	G3/4" whorl	Lead wire	
FA133A	Φ42~Φ54 pipe	Aviation plug connector	4 ~ 20mA three – wire current loop ; load resistance ≤ 500Ω
FA133B	Self-balanced	Lead wire	
FA133D	G3/4" whorl	Lead wire	
FA135A	Φ42~Φ54 pipe	Aviation plug connector	NPN pulse signal; 0.5m / s=2Hz; 50m / s=573 Hz; V[m / s]=0.08669 × f [Hz] + 0.32;
FA135B	Self-balanced	Lead wire	
FA135D	G3/4" whorl	Lead wire	

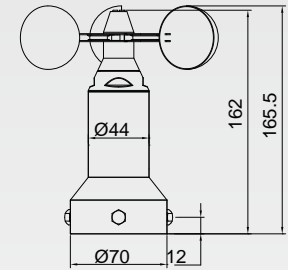
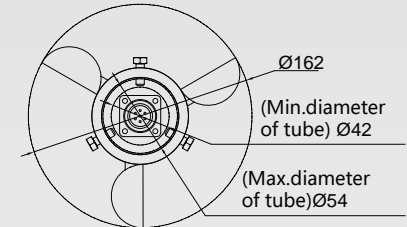

FA131A / FA133A / FA135A

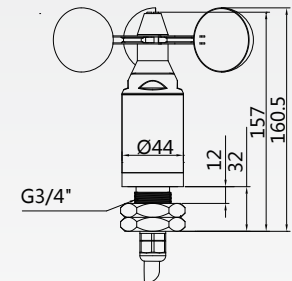

FA131D / FA133D / FA135D